



LEASE PARCEL

A, part of the Northeast Quarter (NE1/4) of the Southwest Quarter (SW1/4) of Section Thirteen (13), Township Two (2) North, Range Fifteen (15) East, City of Delavan, Walworth County, Wisconsin containing 375 square feet (0.009 acres) of land and being described by:

Commencing at the West Quarter (W1/4) Corner of said Section 13; thence N87°-23'-35"E 1759.37 feet along the East/West Quarter line of said Section 13; thence S02°-34'-03"E 37.63 feet to the point of beginning; thence N87°-25'-57"E 25.00 feet; thence S02°-34'-03"E 15.00 feet; thence S87°-25'-57"W 25.00 feet; thence N02°-34'-03"W 15.00 feet to the point of beginning; being subject to any and all easements and restrictions of record.

12 FOOT WIDE INGRESS/EGRESS EASEMENT

A part of Lot Twenty-Six (26) of the FIRST ADDITION TO CHESTNUT RIDGE SUBDIVISION WEST and a part of the Northeast Quarter (NE1/4) of the Southwest Quarter (SW1/4) of Section Thirteen (13), Township Two (2) North, Range Fifteen (15) East, City of Delavan, Walworth County, Wisconsin containing 2,408 square feet (0.055 acres) of land and being 6 feet either side of and parallel to the following described line:

Commencing at the West Quarter (W1/4) Corner of said Section 13; thence N87°-23'-35"E 1759.37 feet along the East/West Quarter line of said Section 13; thence S02°-34'-03"E 37.63 feet; thence N87°-25'-57"E 25.00 feet; thence S02°-34'-03"E 15.00 feet; thence S87°-25'-57"W 12.50 feet to the point of beginning; thence S41°-32'-50"W 56.88 feet; thence S04°-22'-25"W 143.80 feet to a point on the North line of Chestnut Court as platted and the point of termination.

8 FOOT WIDE UTILITY EASEMENT

An 8 foot wide Utility Easement being a part of the Northeast Quarter (NE1/4) of the Southwest Quarter (SW1/4) of Section Thirteen (13), Township Two (2) North, Range Fifteen (15) East, City of Delavan, Walworth County, Wisconsin containing 205 square feet (0.005 acres) of land and being 4 feet either side of and parallel to the following described line:

Commencing at the West Quarter (W1/4) Corner of said Section 13; thence N87°-23'-35"E 1759.37 feet along the East/West Quarter line of said Section 13; thence S02°-34'-03"E 37.63 feet; thence N87°-25'-57"E 25.00 feet; thence S02°-34'-03"E 15.00 feet; thence S87°-25'-57"W 21.00 feet to the point of beginning; thence S02°-34'-03"E 4.00 feet; thence S87°-25'-57"W 21.59 feet to the point of termination.

4 FOOT WIDE COAX EASEMENT

A 4 foot wide Coax Easement being a part of the Northeast Quarter (NE1/4) of the Southwest Quarter (SW1/4) of Section Thirteen (13), Township Two (2) North, Range Fifteen (15) East, City of Delavan, Walworth County, Wisconsin containing 317 square feet (0.007 acres) of land and being 2 feet either side of and parallel to the following described line:

Commencing at the West Quarter (W1/4) Corner of said Section 13; thence N87°-23'-35"E 1759.37 feet along the East/West Quarter line of said Section 13; thence S02°-34'-03"E 37.63 feet; thence N87°-25'-57"E 25.00 feet; thence S02°-34'-03"E 15.00 feet; thence S87°-25'-57"W 25.00 feet; thence N02°-34'-03"W 7.50 feet to the point of beginning; thence S87°-25'-57"W 47.81 feet; thence S02°-34'-03"E 19.16 feet; thence N87°-25'-57"E 12.21 feet to the point of termination.

I, Craig A. Keach, hereby certify that none of the property described hereon is within a flood plane or wetlands area as defined by FEMA or Wisconsin DNR.

# SURVEYOR'S CERTIFICATE

I, Craig A. Keach, Wisconsin Registered Land Surveyor of Aero-Metric Incorporated, certify that I have surveyed the described property and that the map shown is a true and accurate representation thereof to the best of my knowledge and belief.

Dated this 4th day of OCTOBER, 2001.

Craig A. Keach  
WISCONSIN REGISTERED LAND SURVEYOR  
Craig A. Keach, S-2333

- LEGEND -

- = 1" IRON PIPE FOUND
- = 1"x24" IRON PIPE SET
- ▣ = 8" NAIL SET
- △ = P.K. MASONRY NAIL SET
- ⊕ = COUNTY MONUMENT FOUND
- ( ) = RECORDED INFORMATION
- ⚓ = HYDRANT
- ⊗ = WATER VALVE
- = TELEPHONE PEDESTAL
- ===== = PROPERTY LINE
- ⊞ = ELECTRIC TRANSFORMER PAD

BEARINGS REFERENCED TO THE  
WISCONSIN STATE PLANE COORDINATE  
SYSTEM - (NAD 27) SOUTH ZONE

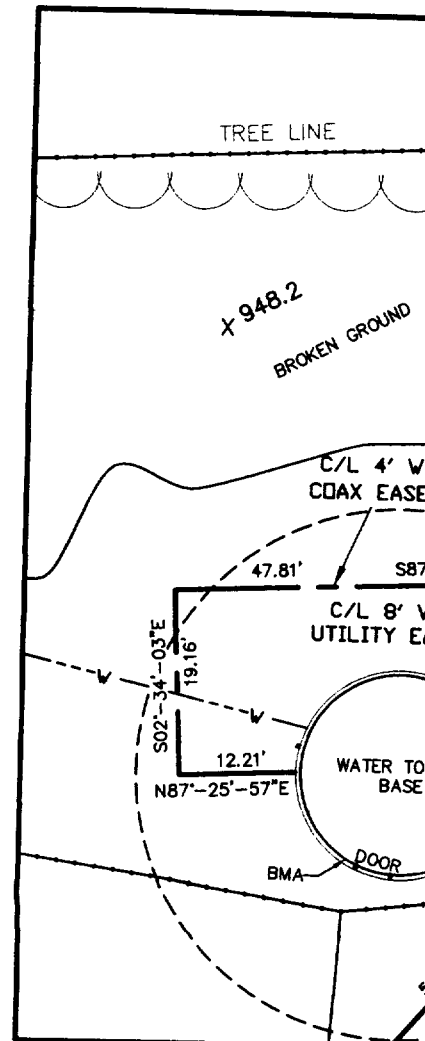

BENCHMARK INFORMATION:

SITE BENCHMARK: (BM A) PAINTED NUT AT TOWER BASE  
WEST OF ACCESS DOOR  
ELEVATION = 952.03'

SCALE: 1" = 20'

